



wic MICHIGAN

BRAND NEW YOU

2018 WIC TRAINING &
EDUCATIONAL CONFERENCE



CONFERENCE INFORMATION

MAY 15 - 16, 2018

Grand Traverse Resort & Spa





WELCOME TO THE **2018 MICHIGAN WIC TRAINING & EDUCATIONAL CONFERENCE**

The Michigan Department of Health and Human Services, WIC Division is excited to welcome you to the 2018 Michigan WIC Training and Educational Conference. The conference brings together experts to speak on current public health and nutrition issues. The purpose of this event is to support WIC's continued commitment to staff who provide excellent service to more than 230,000 clients each year.

MOBILE APP

To download the event app, please visit the Apple Store or Google Play Store and search for **MPHI Event Services**. Select the **GET** or **INSTALL** option. Once installed, open the app and select the **WIC Training & Educational Conference Event**. Press the **Join** button. You will be prompted to create a profile for the app. To join the event itself, use the Event Code **wic2018**.



The mobile app can be used to:

- Manage your personal conference agenda
- Check-in to sessions throughout the conference*
- Post your favorite part of the day or session
- Take and post pictures of the conference
- Access Continuing Education Easy Steps Requirements
- Connect with attendees, presenters, and exhibitors

** Mobile app check-in does not replace the check-in desk sign-in requirement to qualify for CE credits.*



CONTINUING EDUCATION

Continuing Education opportunities are available for Nurses, Registered Dietitians, Dietetic Technicians, and Certified IBCLCs. Look for the CE Easy Steps document you received in your reminder email, or available on the conference mobile app and conference website, for specific steps and requirements needed to be eligible for any applicable Continuing Education. Please note: **You MUST sign in both days at check-in to qualify for CE credits.**

♥ Nurses 🍴 Registered Dietitians/Dietetic Technicians 👤 IBCLCs

MAY 15 AGENDA AT A GLANCE



PLEASE BE SURE TO SIGN IN AT CHECK-IN ANY TIME THROUGHOUT DAY ONE TO ENSURE YOU ARE ELIGIBLE FOR ANY APPLICABLE CONTINUING EDUCATION CREDITS.

8:00 a.m. - 6:00 p.m. Exhibits & IdeaMart Open

Pre-Function Area

7:30 a.m. - 9:15 a.m. Check-In

Tower Ballroom

9:15 a.m. - 10:15 a.m. Welcome & Keynote

Thinking Outside the Box - *Rodney Page, MA*

Governors' A-D

10:15 a.m. - 10:30 a.m. Break, Visit Exhibits & IdeaMart

Pre-Function Area

10:30 a.m. - 11:30 a.m. 100 Concurrent Sessions

101 Autism: Call to Action to Assist Families with Essential Services for the Best Outcome
- *Lisa Grost*

Tower B-C



102 The First Investment in Health: Understanding How Human Milk Changes the Epigenome and Microbiome

Michigan A-D

- *Laurel Wilson, BSc, IBCLC, CCCE, CLE®, CLD, CPPFE, CPPI*



103 Addressing Tobacco Use Among Pregnant and Parenting Women in Michigan
- *Farid Shamo, MB ChB, MPH;*
Molly Cotant, BS, MPH

Peninsule B-C



104 MI-WIC and EBT System Updates: A Decade of Developments - *Bagya Kodur, MS;*
Kristina Ressler, MPH; Anthony Spagnuolo, BAA

Mackinac Ballroom



105 Opioid Overdose Prevention and Education
- *Sarah Kenney, BS, MSW*

Tower A



MAY 15 AGENDA AT A GLANCE

11:30 a.m. - 1:00 p.m. Lunch & State of Michigan WIC Updates

Governors' A-D

1:00 p.m. - 1:20 p.m. Break, Visit Exhibits & IdeaMart

Pre-Function Area

1:20 p.m. - 2:20 p.m. 200 Concurrent Sessions

201 Lead 101: The Role of Health Care Professionals -
Karen Lishinski, RN, MA, AE-C

Tower A



202 Transforming the Narrative on Breastfeeding and
Black Families - Andrea Serano, IBCLC, CLC

Michigan E-H



203 Autism Spectrum Disorder: Diet, Nutrition, and
Behavior Considerations - Stacie Rulison

Tower B-C



204 WIC Health Outcomes, Data Quality and Relation
Between Them - Wei Xue, PhD; Amy Dotson, MPH

Mackinac Ballroom

205 Infant Safe Sleep: The Nuts & Bolts of Working
with Families - Patti Kelly, LMSW, MPH;
Colleen Nelson, LMSW

Peninsula A



206 Integrated Service Delivery in Michigan
- Phillip Bergquist

Peninsula B-C



2:20 p.m. - 2:40 p.m. Break, Visit Exhibits & IdeaMart

Pre-Function Area

2:40 p.m. - 4:10 p.m. Block Session 1

Up In Smoke: The Potential Impact on Babies of Cannabis Use During
Pregnancy and Lactation - Laurel Wilson, Bsc, IBCLC, CLE, CLD, CCCE



Michigan A-D

4:10 p.m. - 6:00 p.m. Networking Reception

Governors' Hall

5:00 p.m. - 6:00 p.m. Special Event

Wonderful World of Chocolate - Patrick Fields, PhD

Governors' F

MAY 16 AGENDA AT A GLANCE



PLEASE BE SURE TO SIGN IN AT CHECK-IN ANY TIME THROUGHOUT DAY TWO TO ENSURE YOU ARE ELIGIBLE FOR ANY APPLICABLE CONTINUING EDUCATION CREDITS.

6:30 a.m. - 7:30 a.m. Happy Healthy Morning Exercise

Tower A

7:30 a.m. - 12:00 p.m. Exhibits & IdeaMart Open

Pre-Function Area

7:30 a.m. - 8:45 a.m. Kellogg Breakfast

Governors' A-E

8:45 a.m. - 9:00 a.m. Break, Visit Exhibits & IdeaMart

Pre-Function Area

9:00 a.m. - 10:00 a.m. 300 Concurrent Sessions

301 That Was Rough: Strategies for Connecting with Hard to Reach Clients - *Monica Smith*

Governors' F



302 Use of Mothers' Own Milk and Breastfeeding in the Neonatal Intensive Care Unit
- *Paula Meier, PhD, RN*

Michigan A-D



303 Gestational Diabetes: From Screening to Delivery and Beyond - *Patti Hennrick, BS, RD, CDE*

Michigan E-H



305 Human Trafficking: A Survivor Success Story -
Ruth Rondon

Tower B-C



10:00 a.m. - 10:15 a.m. Break, Visit Exhibits & IdeaMart

Pre-Function Area

10:15 a.m. - 11:45 a.m. - Block Session 2

Understanding ACEs: Building Self-Healing Communities
- *Robert Anda, MD, MS*

Michigan A-D



MAY 16 *AGENDA* AT A GLANCE

11:45 a.m. - 12:00 p.m. Break, Visit Exhibits & IdeaMart

Pre-Function Area

12:00 p.m. - 1:00 p.m. Lunch

Governors' A-D

1:00 p.m. - 1:15 p.m. Break

1:15 p.m. - 2:15 p.m. - 400 Concurrent Sessions

401 I Don't Make the Rules: How to Maintain Program Integrity Without Being the Bad Guy
- *Monica Smith*

Governors' F



402 Common Breastfeeding Problems and Techniques to Use With Late Preterm and Early Preterm Infants - *Paula Meier, PhD, RN*

Michigan A-D



403 Nutritional Considerations in Pediatric Patients with Eosinophilic Esophagitis: Perspectives from the Dietitian and Patient - *Liz Hudson; Shay Kyle*

Michigan E-H



404 Reports in MI-WIC: A Primer to Improve Productivity - *Bagya Kodur, MS*

Mackinac Ballroom

405 Now What? Applying the Science of ACEs/Trauma to WIC Services
- *Mary Mueller, MSW, LMSW*

Director's Room



2:15 p.m. - 2:30 p.m. Break

2:30 p.m. - 3:30 p.m. Block Session 3

Hot Topics in Nutrition: How Trends Impact What America Eats
- *Kathleen Zelman, MPH, RDN*



Michigan A-D

3:30 p.m. Adjourn

MAP

Grand Traverse
Resort and Spa



LOBBY LEVEL

BREASTFEEDING SUITE



Located on the lobby level in the Northwoods room. Please stop by the conference check-in desk in the Tower Ballroom for a key.

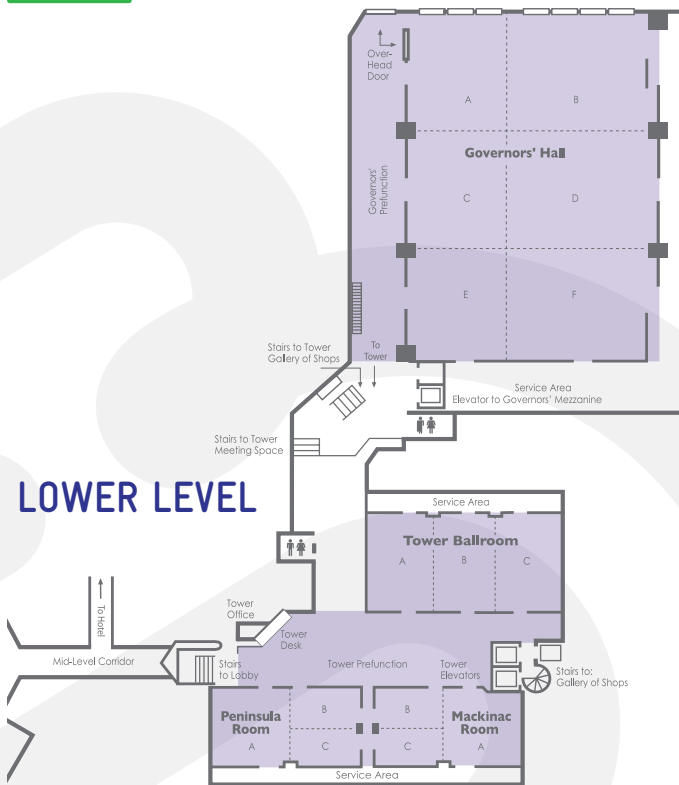



EXHIBITORS

Be sure to check out the exhibitors, located in the Pre-Function areas, throughout the conference.

Exhibitors include:

AstraZeneca	Baby Carriers Provided
Beech-Nut	DanoneWave
Destination Ann Arbor	Early On Michigan
U.S. Food & Drug Administration	Fresh Baby, LLC
General Mills	Gerber Products Company
Harvest Hill Beverage Company	Hemocue America
Kelloggs	Learning ZoneXpress
MDHHS - Bureau of Community Services	MDHHS - Childhood Lead Poisoning Prevention Program
MDHHS - Oral Health Division	MDHHS - Tobacco Prevention & Control Program
Mead Johnson & Company, LLC	Medela
Michigan Ag Council - Michigan Potatoes	Michigan Breastfeeding Network
Michigan's Safe Delivery of Newborns Law	Milk Means More
Nutrition Matters	Pacific Foods
Perspective Enterprises	Post Consumers
Riviana Foods Inc.	Stanbio Laboratory/ EKF Diagnostics for Life
Traverse City Tourism	Welch Foods Inc.



IDEAMART

IdeaMart is an exciting opportunity for WIC agencies to share special ideas that have turned into creative examples of WIC ingenuity. These ideas have enhanced programs and we encourage you to get inspired by visiting these displays located in the Pre-Function areas.



COORDINATOR SUMMIT

JOIN US!

OCTOBER 23 - 24, 2018

DoubleTree Bay City Riverfront
1 Wenonah Park Pl, Bay City, MI 48708

Looking for other educational opportunities?

For a complete calendar of events including online registration for all WIC Training opportunities as well as other available educational programs, visit:

events.mphi.org

Notes:

**Thank you for attending!
We'll see you in 2019!**